

**DEVELOPMENT STATISTICS**

**Overall**

Total Site Area (Deed)	25.482 ha
Total No. of Allotments	47
Total Allotment Area	18.335 ha
Average Allotment Area	3901 m <sup>2</sup>
Total Area of Buffer/Open Space/Drainage Reserve	1.59 ha
Total Area of Drainage Reserve	1.302 ha
Total Area of New Road	4.266 ha
Total Length of 30m Wide Road	426 m
Total Length of 22.6m Wide Road	1259 m

**Stage 1**

Total Stage 1 Area	14.459 ha
Total No. of Allotments	19
Total Allotment Area	11.077 ha
Average Allotment Area	5830 m <sup>2</sup>
Total Area of Buffer/Open Space/Drainage Reserve	1.0 ha
Total Area of Drainage Reserve	1417 m <sup>2</sup>
Total Area of New Road	2.24 ha
Total Length of 30m Wide Road	283 m
Total Length of 22.6m Wide Road	559 m

**Stage 2**

Total Stage 2 Area	4.871 ha
Total No. of Allotments	14
Total Allotment Area	3.02 ha
Average Allotment Area	2157 m <sup>2</sup>
Total Area of Buffer/Open Space/Drainage Reserve	5894 m <sup>2</sup>
Total Area of Drainage Reserve	3485 m <sup>2</sup>
Total Area of New Road	9136 m <sup>2</sup>
Total Length of 22.6m Wide Road	398 m

**Stage 3**

Total Stage 3 Area	6.163 ha
Total No. of Allotments	14
Total Allotment Area	4.238 ha
Average Allotment Area	3027 m <sup>2</sup>
Total Area of Drainage Reserve	8119 m <sup>2</sup>
Total Area of New Road	1.113 ha
Total Length of 30m Wide Road	143 m
Total Length of 22.6m Wide Road	302 m

**LEGEND**

- - - Site Boundary
- Buffer/Open Space/Drainage Reserve
- Drainage Reserve

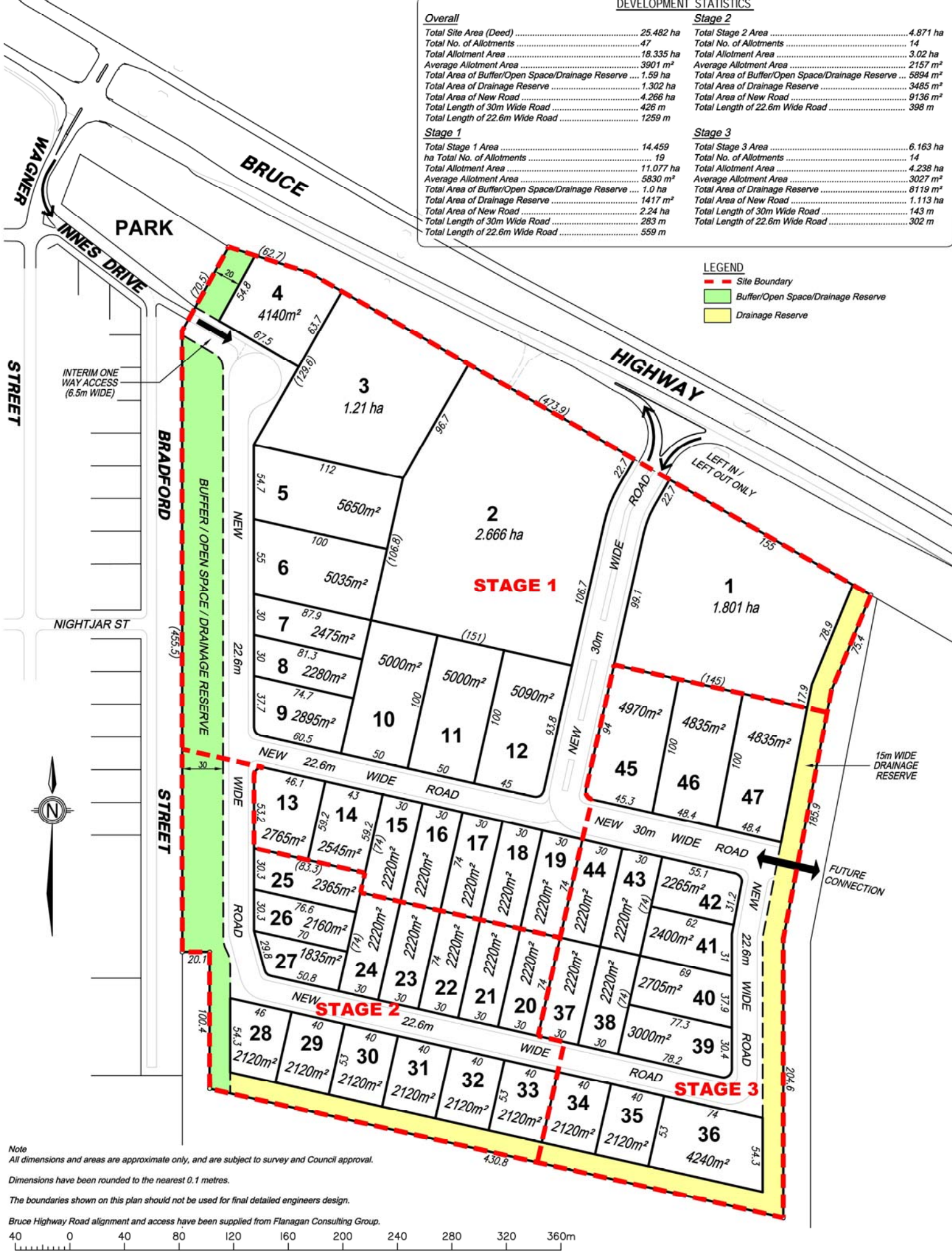

Note  
All dimensions and areas are approximate only, and are subject to survey and Council approval.

Dimensions have been rounded to the nearest 0.1 metres.

The boundaries shown on this plan should not be used for final detailed engineers design.

Bruce Highway Road alignment and access have been supplied from Flanagan Consulting Group.

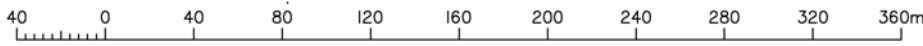

Scale 1:2500

Level Datum	Date	03-04-2009	
Origin	Plan Meridian	RP747112	
	Surveyed	Comp By.	CP
	DWG Name.	83053-13B	
Scale	Local Authority	TOWNSVILLE CITY COUNCIL	
1:2500 @ A3	Job Reference	83053	

CLIENT	<b>STATELAND PTY LTD</b>
	STAGING PLAN
	OVER LOT 1 ON RP 747112
	(47 LOTS & NEW ROADS)

PROJECT	<b>PROPOSED SUBDIVISION</b>
Plan Reference	<b>83053-13B</b>

**CONICS** (Townsville) Pty Ltd  
A.B.N. 98 117 672 572

**Townsville Office**  
Suite 1, Ground Floor, Central Plaza  
370 Flinders Mail (PO Box 977)  
Townsville Qld Australia 4810  
[www.conics.com.au](http://www.conics.com.au)  
t 07 4724 4244  
f 07 4724 4144  
e [townsville@conics.com.au](mailto:townsville@conics.com.au)

© COPYRIGHT PROTECTS THIS PLAN  
Unauthorized reproduction or amendment  
not permitted. Please contact the author.